

jari "MONARCH"

1987

MODEL "C" REPAIR PARTS LIST AND OWNER'S MANUAL

CAUTION

Never attempt to work on your Jari Mower without first grounding the spark plug. Never wear loose clothing in the vicinity of the unit when the engine is operating. Before starting the engine, clear the area of adults, children and pets. A sudden gust of wind and/or an unexpected move on somebody's part can change what was regarded as a safe situation. **Always exercise caution** during the operation, handling, parking or storage of your mower. Engine must be shut off and allowed to cool off before attempting to refuel. Stop engine before attempting to clean any debris from knife assembly.

LUBRICATION (5 Zerks)

Use heavy-duty gun grease every 10 hours of operation. If one grease retainer, such as item #39 is used in conjunction with part requiring grease, grease until grease appears at the retainer. If two grease retainers are used, such as with each wheel or dual pulley #59, grease until grease appears at both retainers. It is not necessary to remove fender for greasing. Drive shaft has sealed ball bearings, which do not require greasing.

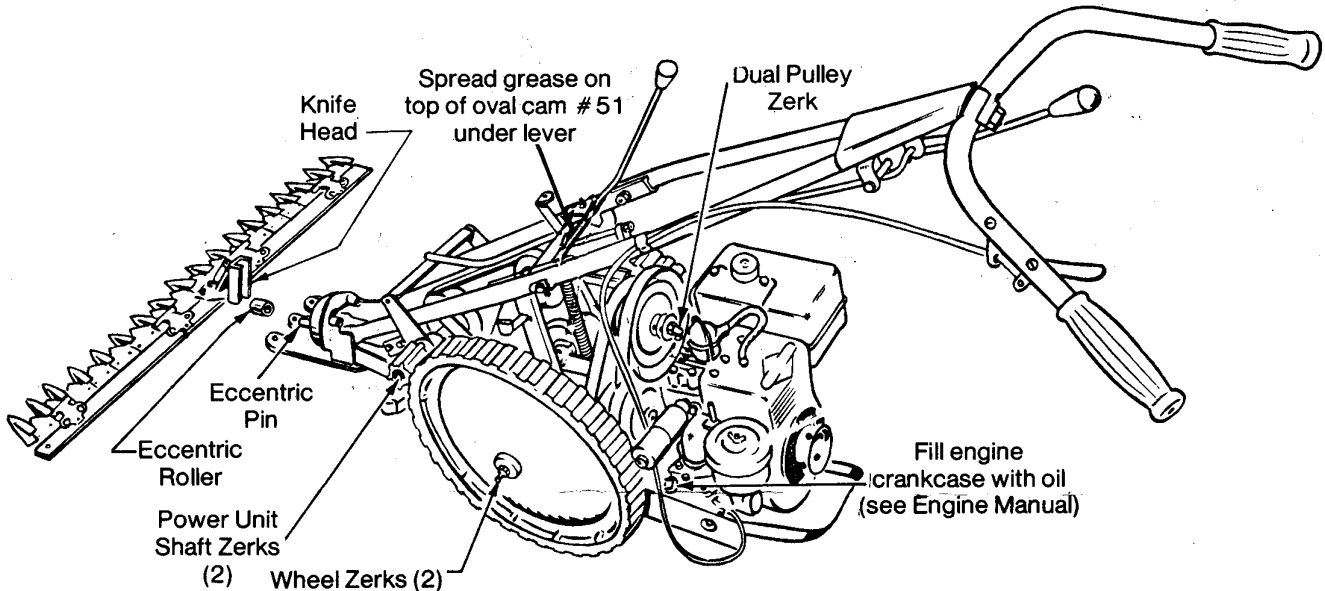

Fill in data on your new Jari. Give this information when ordering parts from your dealer or distributor.

NAME OF DEALER OR DISTRIBUTOR

Jari Serial Number (located on frame under engine).

Date Purchased _____

Engine (2 numbers located on engine in form of decal and/or stamped into flywheel housing).

Make _____ Model # _____

H.P. _____ Type # _____

jari DIVISION OF YEAR-A-ROUND CAB CORP.

BOX 2075 HWY. 169 N. MANKATO, MINN. 56001 PHONE: 507 625-9381

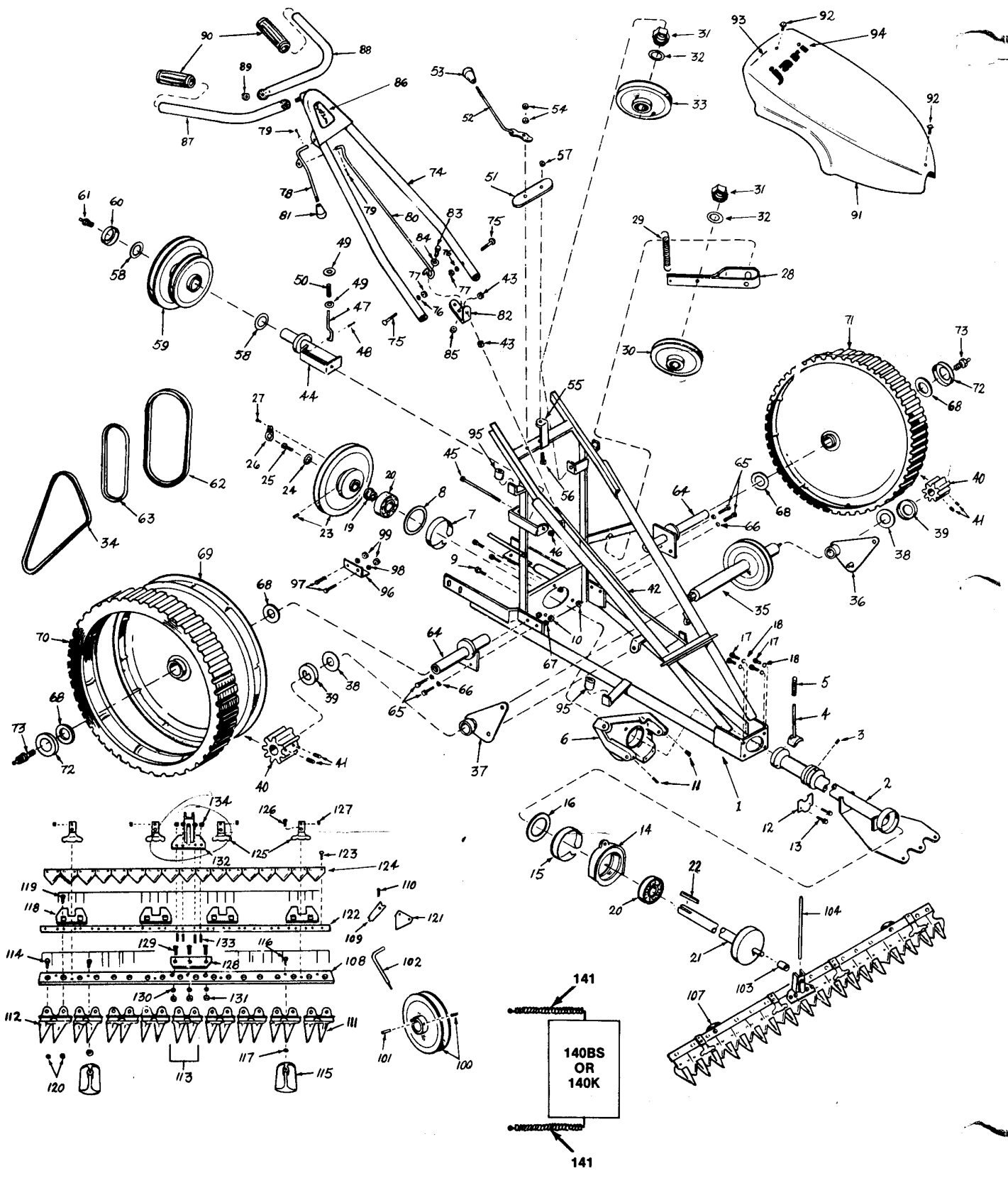

PARTS AND ACCESSORIES

ITEM	PART	DESCRIPTION	QUAN.	ITEM	PART	DESCRIPTION	QUAN.
1	117400	Frame Assembly	1	69	110610	Wheel Assembly	1
2	103510	Drive Shaft Housing Assembly	1	70	110000	Tire	1
3	900158	Socket Head Set Screw 5/16-18 x 3/8"	1	71	110010	Tire and Wheel Assembly	2
4	100700	Swivel Return Rod Assembly	1	72	114600	Felt Retainers (For Wheels)	2
5	101000	Return Spring	1	73	104610	Cap Screw/Zerk Assembly	2
6	100510	Rear Swivel Casting	1	74	107610	Handle Bar Fork Assembly	1
7	100600	Nylon Bearing	1	75	900168	Curved Handle Bar Bolts 3/8-16 x 2"	2
8	314700	Felt Washer	1	76	900162	Internal Tooth Lock Washers 3/8"	2
9	900074	Hex Head Cap Screw 5/16-24 x 3/4"	3	77	900045	Hex Nut 3/8-16"	2
10	900171	Hex Lock Nut 5/16-24"	3	78	107900	Shift Lever Assembly	1
11	900158	Socket Head Set Screw 5/16-18 x 3/8"	2	79	900167	Cotter Pin 3/32 x 3/4" Long	2
12	101500	Thrust Plate	1	80	115410	Upper Control Rod	1
13	900182	Truss Head Sem Screw 1/4-20 x 1/2"	2	81	108100	Control Knob	1
14	100420	Front Swivel Casting	1	82	115600	Control Rod Bracket	1
15	100600	Nylon Bearing	1	83	900072	Hex Head Cap Screw 5/16-18 x 1" Plated	1
16	314700	Felt Washer	1	84	900019	Flat Washer (Standard) 5/16" Rivet Burr	1
17	900184	Socket Head Cap Screw 3/8-16 x 3/4"	4	85	900031	Hex Nut 5/16-18"	1
18	900162	Internal Tooth Lock Washer 3/8"	4	86	117810	Handle Bar Decal	1
19	104400	Bearing Sleeve	1	87	107510	Handle Assembly RH	1
20	104210	Bearing	2	88	107540	Handle Assembly LH	1
21	109910	Drive Shaft Assembly	1	89	900172	Hex Nut 1/2-20"	1
22	105000	Key 3/16 x 3/16 x 2-1/4"	1	90	108200	Handle Grip	2
23	104900	Pulley—Twin W/Set Screw	1	91	117500	Fender Assembly	1
24	900048	Standard Wrought Washer 1/2"	1	92	900182	Truss Head Sems (Fender) 1/4-20 x 1/2"	2
25	900186	Hex Head Cap Screw 1/2-20 x 1-1/4"	1	93	119600	Start-Run Decal	1
26	105410	Thrust Adjusting Clip	1	94	217800	"Jari" Fender Decal	1
27	900187	Round Head Sem Screw 10-32 x 3/8"	1	95	203810	Rubber Tube	4
28	101120	Lower Idler Assembly	1	96	100902	Motor Support Bracket	1
29	107000	Idler Spring	1	97	900183	Cap Screw Sems 3/8-16 x 3/4"	2
30	201300	Bottom Idler Pulley	1	98	900162	Internal Tooth Lock Washer	2
31	900172	Hex Nut—Plated 1/2-20"	2	99	900045	Hex Nuts 3/8-16" Plated	2
32	900175	Internal Tooth Lock Washer 1/2"	2	100	111300	Motor Pulley W/Set Screw	1
33	201400	Upper Idler Pulley	1	101	111400	Motor Shaft Key 3/16 x 3/16 x 1-3/8"	1
34	112100	Pulley Belt (54")	1	102	112200	P-122 Allen Wrench Assembly	1
35*	105810	Power Unit Assembly	1	103	104800	Eccentric Roller	1
36	106140	Power Unit Bracket Assembly LH	1	104	102700	Divider Rod	1
37	106110	Power Unit Bracket Assembly RH	1	107	103600	36" Sickle Bar Assembly	1
38	114700	Felt Washer	2	108	102800	Guard Bar	1
39	114620	Felt Retainer	2	109	300200	Ledger Plate	18 or 22
40	105910	Drive Pinion	2	110	900178	Countersunk Rivet 5/32 x 1-1/4"	18-22
41	900158	Socket Head Set Screw 5/16-18 x 3/8"	4	111	201810	Left End Guard Assembly	1
42	115500	Lower Control Rod Assembly	1	112	101810	Right End Guard Assembly	1
43	900165	Hex Jam Nut 7/16-20"	2	113	101710	Center Guard Assembly	7 or 9
44	119110	Dual Pulley Hinge Bracket Assembly	1	114**	900160	Guard Bolt	10
45	900233	Hex Head Cap Screw 5/16-24 x 4"	1	115	100800	Skid	2
46	900188	Hex Jam Nut 5/16-24"	1	116	900161	Hex Head Cap Screw 3/8-16 x 1-1/8" Plain	2
47	119500	Belt Tightener Rod	1	117	900162	Internal/ Tooth Lock Washer 3/8"	2
48	900167	Cotter Pin 3/32" Dia. x 3/4" Long	1	118	102900	Wear Plate	4
49	900189	Washer (Special) 11/16" OD x 11/32" ID	2	119	900159	Carriage Bolts 3/8-16 x 1" Plain	8
50	109000	Belt Tightener Spring	1	120**	900163	Hex Jam Nuts 3/8-16"	18 or 22
51	119300	Belt Tightener Cam Oval	1	121	102500	P-25 Knife Sections (Smooth)	17 or 21
52	119400	Belt Tightener Lever Assembly	1	122	102600	P-26 Knife Back (36")	1
53	108100	Knob	1	123	900177	Rivet—Round Head 3/16 x 1/2"	30 or 38
54	900188	Hex Jam Nut 5/16-24"	2	124***	102510	Knife Assembly 36" Smooth	1
55	117900	Rear Fender Support	1	125	300400	4-H Knife Clip	4 or 6
56	900166	Hex Head Cap Screw 5/16-24 x 1"	1	126	900074	Hex Head Cap Screw 5/16-24 x 3/4"	4 or 6
57	900075	Hex Nut 5/16-24"	1	127	900158	Socket Head Set Screw 5/16-18 x 3/8"	4 or 6
58	114700	Felt Washer	2	128	103000	Head Wear Plate	1
59	119000	Dual Pulley Assembly	1	129	900164	Guard Bolts 3/8-16 x 1-1/4"	3
60	114600	Felt Retainer Assembly	1	130	900004	Split Lock Washer 3/8" Standard	3
61	107320	Zerk Bolt Assembly (67-1/2° Zerk)	1	131	900045	Hex Nuts 3/8-16"	3
62	211900	Pulley Belt (34")	1	132	100100	C-1 Knife Head Assembly	1
63	112000	Motor Belt (30-1/2")	1	133	900156	Socket Head Cap Screws 10-32 x 11/16" S	4
64	104100	Axle Assembly	2	134	900157	Flex Lock Nuts 10-32"	4
65	900050	Hex Head Cap Screw 3/8-16 x 3/4"	4	140BS	100007	Recoil Housing Guard (for 3 & 4 H.P. Briggs & Stratton engine)	1
66	900162	Internal Tooth Lock Washer 3/8"	4				
67	900045	Hex Nut 3/8-16"	4	140K	100008	Recoil Housing Guard (4 H.P. Cast Iron Kohler Engine)	1
68	114700	Felt Washers	4	141	100012	Recoil Housing Guard Spring	2

*Item # 35 is pulley and shaft only. If complete power unit assembly is needed including items 35, 36, 37, 38, 39, 40 and 41, order one 109800.

**Use 900159, 900004 and 900045 to replace 900160 and 900163.

***Item 124 consists of items 121, 122 and 123 assembled.

NOTE: When two sets of figures appear under quantity, lesser figure refers to 36" bar, larger figure refers to 44" bar. For Monarchs equipped with sickle bars other than above contact dealer or distributor for parts breakdown. Part numbers are the same except on guard bars, knife assemblies and knife backs. Quantities will vary depending on length of bar.

as you mow across the face of the slope. Make 2 minute passes and when turning around, carefully walk above your mower. At the top of your turn, push down on handle bars to level up crankcase.

8. If you encounter hard wood saplings up to 1-3/8" in size, release self-propelled lever and gradually push mower into sapling. Knife assembly will saw its way through.

9. If sickle bar becomes lodged under a rock or heavy object, **do not** push down on handle bars. Pull unit straight back. Failure to do so will force knife head away from drive head and lead to repairs.

WINTER STORAGE

1. Gas tank, fuel line and carburetor should be drained. Gasoline, if allowed to stand, will form a gummy substance. Gum can only be removed by a solvent.

SICKLE BAR ADJUSTMENTS

1. Knife clips #125 control up and down movement of knife assembly #124. To adjust, **do not** loosen bolt #126—turn set screw #127 clockwise to tighten, counterclockwise to loosen. Tighten clips so they are tight without binding. Clips that bind will overheat, damage and groove knife assembly. To test for binding, ground spark plug, place sickle bar lever in start position and turn twin pulley #23 by hand or after 2 minutes running, stop engine and carefully feel clips for heat. Clips should be warm to the touch—not hot.

Each knife section #121 in knife assembly #124 should contact a ledger plate #109, located in each guard such as #111, similar to a well-adjusted pair of scissors.

Socket head screws #133, nuts #134 and knife assembly #124, although specially hardened, will break and cause poor cutting if socket screws are not tight and knife clips are not properly adjusted. Knives that are dull will also create problems. Sharpen with file or Jari Sickle Grinder.

Wear plates #118, located around each knife clip, control front to back movement of knife assembly. To correct front to back play, slightly loosen nuts on 2 bolts #119 in each wear plate and tap wear plate forward with hammer. Adjust and tighten inner wearing plates first, then outer wearing plates.

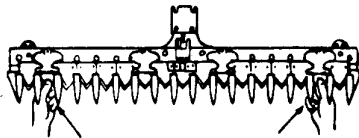

TO TEST FOR LOOSENESS OF KNIFE ASSEMBLY, GRASP TIPS IN FRONT OF EACH KNIFE CLIP, AS SHOWN ABOVE AND ATTEMPT TO MOVE UP AND DOWN AND FRONT TO BACK.

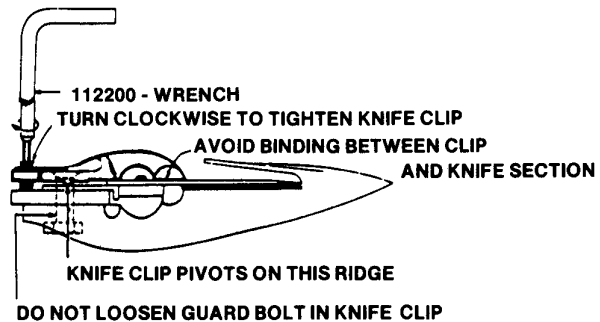

JARI "MONARCH" PROBLEM SOLVING CHART:	
PROBLEMS	SOLUTIONS
1. Won't cut cleanly—stalls too often.	1. A. Blades need sharpening, too dull. B. Knife clips need adjusting (see above). C. Carburetor needs adjusting.
2. Excessive breakage of Socket Head Screws.	2. A. Knife is too loose, adjust clips (see above). B. Tighten Socket Head Screws.
3. Motor runs—sickle works—won't self-propel itself.	3. A. Check to see that all belts are on pulleys. B. Check Idler Spring (broken?).
4. Motor runs but the sickle stops when it gets under load.	4. A. Caused by slippage of Dual Pulley Belt. Adjust tension as described above (belt tightening).
5. Lack of power.	5. A. Knife clips may be binding, too tight (see above). B. Check Drive Pinion Tension (above). C. Check carburetor adjustment.